

RECOMMENDED P.C.B. LAYOUT
TOLERANCE: ±0.05 TOP VIEW

PGB AREA
CONNECT AREA
KEEP OUT AREA

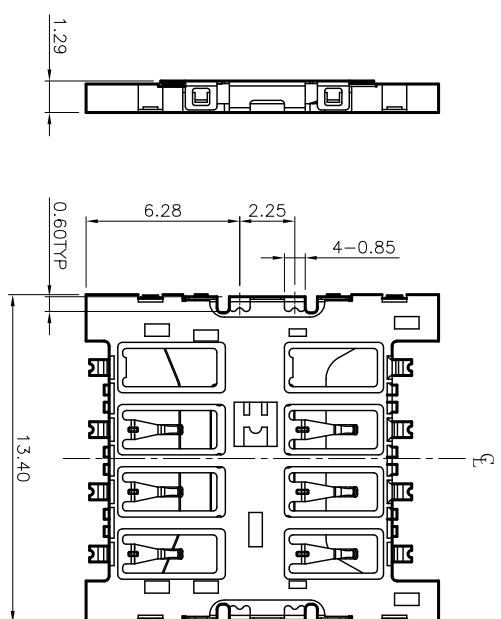
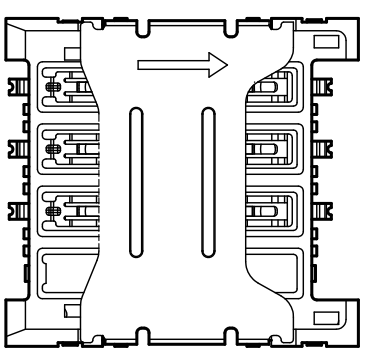
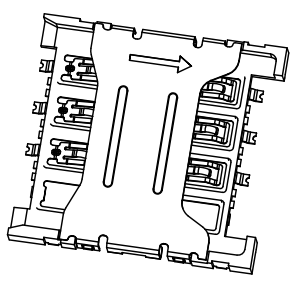

| | | | | | | | |
|-------------------|------------|----------|-------------------------------|--|------------|-------|-----|
| GENERAL TOLERANCE | | DWG NO. | JYSA1205-001 | APPD: | WIND | Scale | 1:1 |
| X±0.45 | X:±5' | Title | MICRO SIM 6PIN 1.30H 防燙PIN | CHKD: | | UNIT | mm |
| X±0.35 | X:±2' | Part NO. | JYS-SIM130-091 | DR: | | | |
| XX±0.25 | .XX'±1' | | | Date | 2013/12/29 | | |
| .XXX±0.15 | .xxx'±0.5' | SHEET | 1/1 | 杰宇森电子有限公司 JIE YU SEN ELECTRONIC CO., LTD. | | | |

| DESCRIPTION OF PLATING ON TERMINALS | | | |
|-------------------------------------|------------|-----|-----------|
| NO. | EXPLAIN | NO. | EXPLAIN |
| 0 | GOLD FLASH | 3 | GOLD 15u" |
| 1 | GOLD 5u" | 4 | GOLD 20u" |
| 2 | GOLD 10u" | 6 | GOLD 30u" |

SPECIFICATION

1. CURRENT RATING : 1.0 A MAX.
2. DIELECTRIC WITHSTANDING VOLTAGE : 500V AC R.M.S. FOR ONE MINUTE.
3. INSULATION RESISTANCE : 1000M Ω/MIN. AT 500V DC.
4. CONTACT RESISTANCE : 30m Ω/MAX.
5. OPERATING TEMPERATURE : -40C TO +85C.

MATERIALS

1. HOUSING : THERMOPLASTIC (UL 94V-0) .
2. TERMINAL : COPPER ALLOY,
PLATING : GOLD PLATED ON CONTACT AREA
AND SOLDER TAILS,NICKEL PLATED OVERALL.
3. SHELL : STAINLESS STEEL.
PLATING : NICKEL PLATED OVERALL.
GOLD PLATED ON SOLDER TAILS

| REV. | EGN.NO. | MODIFY/CONTENT | DATE |
|------|---------|----------------|------------|
| A | | NEW | 2013/12/29 |