

REV.	EGN.NO.	MODIFY CONTENT	DATE
A		NEW	2017/11/25

- NOTES:
- ELECTRICAL CHARACTERISTICS:
 - 1.1 CONTACT CURRENT RATING: 8A
 - 1.2 CONTACT RATED VOLTGE: 30VAC;
 - 1.3 CONTACT RESISTANCE:

INITIAL: V-BUS/GND PIN 30mohm Max.
 OTHER CONTACTS PIN 40mohm Max.
 AFTER DURABILITY: CHANGE OF +10mohm.
 1.4 INSULATION RESISTANCE: 100 Mohm Min.
 1.5 WITHSTANDING STRENGTH: 100V AC FOR 1 MINUTE.

- MECHANICAL CHARACTERISTICS:
- 2.1 INSERTION FORCE: 5~20N.
- 2.2 EXTRACTION FORCE: 8~20N.
- 2.3 DURABILITY: 10K CYCLES.
- DIMENSIONS MARKED WITH ☆ MUST BE CPK MEASURED BY QC AND PQC
4. RoHS OR HF COMPLIANT.

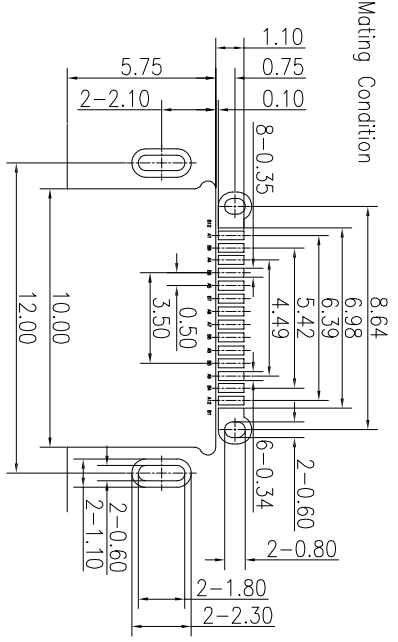
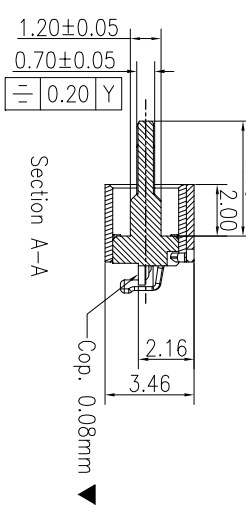
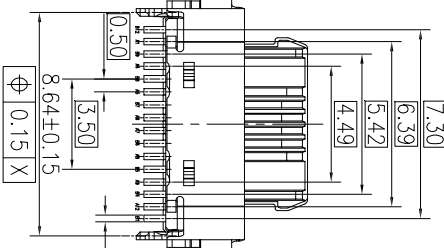
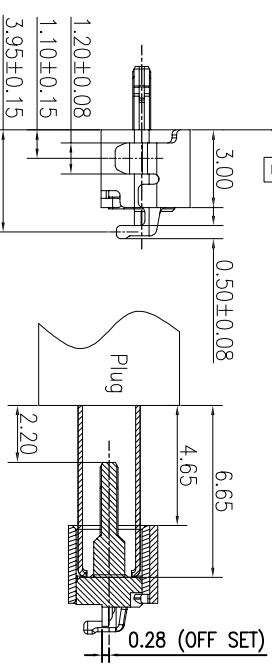
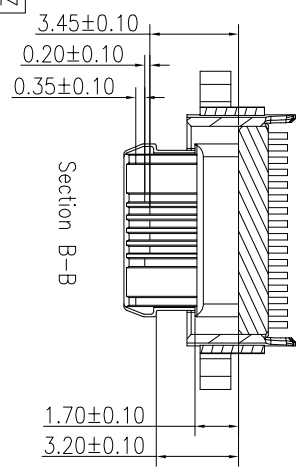
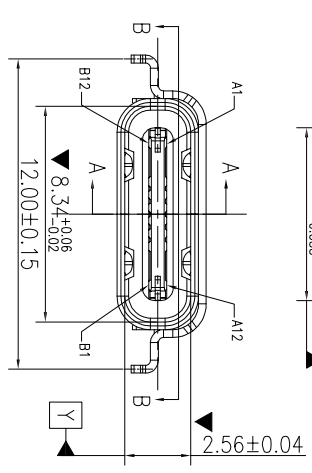
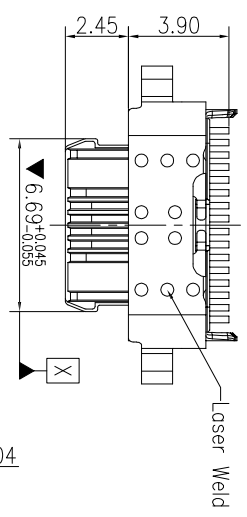

Recommended PCB Layout
 Tol: ±0.05mm

ITEM	PART NAME	Q'TY	MATERIAL	FINISH
7	MAIN SHELL	1	SUS304-1/2H: L=0.30mm	OVER ALL: 50u"Min. NI UNDERPLATED.
6	SUB SHELL	1	SUS304-1/2H: L=0.30mm	UL94V-0
5	OVER MOLDING	1	PA46 NYLON BLACK	UL94V-0
4	FIRST MOLDING	1	PA46 NYLON BLACK	UL94V-0
3	SHIELDING PLATE	1	SUS301-H: T=0.20mm	OVER ALL: 50u"Min. NI PLATED
2	BOTTOM CONTACT	1	C18400-R480; T=0.25mm	OVER ALL: 50u"Min. NI UNDERPLATED, CONTACT AREA: 30u"Min. Au PLATED, SOLDER TAIL: 1u"Min. Au PLATED.
1	TOP CONTACT	1	C18400-R480; T=0.25mm	

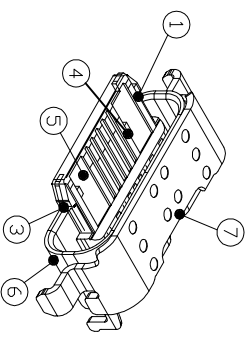

GENERAL TOLERANCE	DWG NO.	JYSA0413-02	APPD:	WIND	Scale	1:1
X±0.45	X:±5'	USB 2.0 Type-C Receptacle 16PIN 4DIP	CHKD:		UNIT	mm
X±0.35	X:±2'		DR:			
.XX±0.25	.XX±1'	Part NO.	Date	2017/11/25		
.XXX±0.15	.xxx±0.5'					
SHEET	1/1					

JYS 杰宇森电子有限公司
 JIE YU SEN ELECTRONIC CO., LTD.